



Green Pin® JJ Turnbuckle BN - G-6323

Turnbuckle with jaw-jaw end-fitting and safety bolt, generally to ASTM F1145-92

Product details

Product code	G-6323
Material	drop forged high tensile steel SAE 1035 or 1045
Safety factor	MBL equals 5 x WLL
Finish	hot dipped galvanized
Certification	2.1 2.2 3.1 MTCa CE
Standard	generally to ASTM F1145-92, formerly U.S. Federal Specification FF-T-791b

Description

The Green Pin® JJ Turnbuckle BN is a turnbuckle with jaw-jaw end-fitting used for both lifting and lashing. The turnbuckle also offers a double safety (cotter pin and safety bolt) which prevents accidental unscrewing and a safety bolt, generally to ASTM F1145-92. One of the unique features of Green Pin® Turnbuckles such as this one is that they can be of the pin. The Green Pin® JJ Turnbuckle BN is available in a range with a diameter thread of 1/2" (take up of 12") up to 1 3/4" (take up of 18").

WARNING: NEVER EXCEED WORKING LOAD LIMIT!

Failure to follow instructions can result in serious property damage, injury or death! For more information please see the turnbuckle warning information found in the hardware section of this catalogue

Highlights

- Can be used for both lifting and lashing
- Double safety (cotter pin & safety bolt)
- Reliable Green Pin® quality and support

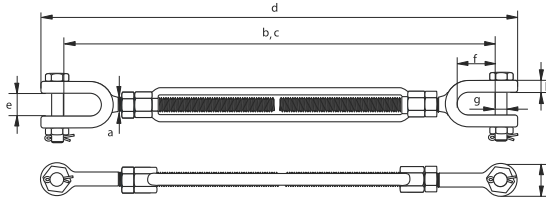

CAD RFID

Item code	WLL Tonne	take up (INCH)	DIMENSIONS (in.)									Net weight LBS
			A	B	C	D	E	F	G	H	I	
SSGPGG1006	0.54	6	3/8	10.75	16.10	11.97	0.47	0.83	0.28	0.35	0.83	1.21
SSGPGG1206	1.00	6	1/2	11.97	17.13	13.50	0.63	1.02	0.39	0.43	0.98	2.14
SSGPGG1209	1.00	9	1/2	14.92	23.15	16.46	0.63	1.02	0.39	0.43	0.98	2.54
SSGPGG1212	1.00	12	1/2	17.91	29.13	19.45	0.63	1.02	0.39	0.43	0.98	3.04
SSGPGG1606	1.59	6	5/8	13.62	18.46	15.98	0.71	1.26	0.51	0.55	1.30	3.86
SSGPGG1609	1.59	9	5/8	16.57	24.49	18.90	0.71	1.26	0.51	0.55	1.30	4.72
SSGPGG1612	1.59	12	5/8	19.61	30.47	21.93	0.71	1.26	0.51	0.55	1.30	5.36
SSGPMBGG1906	2.36	6	3/4	14.53	19.17	17.28	0.94	1.50	0.63	0.63	1.61	5.95
SSGPMBGG1909	2.36	9	3/4	17.48	25.20	20.24	0.94	1.50	0.63	0.63	1.61	7.12
SSGPMBGG1912	2.36	12	3/4	20.47	31.18	23.23	0.94	1.50	0.63	0.63	1.61	7.87
SSGPMBGG1918	2.36	18	3/4	26.38	43.15	29.13	0.94	1.50	0.63	0.63	1.61	10.03
SSGPMBGG2212	3.27	12	7/8	22.09	32.52	25.12	1.06	1.65	0.75	0.75	1.89	11.51
SSGPMBGG2218	3.27	18	7/8	28.07	44.57	31.10	1.06	1.65	0.75	0.75	1.89	14.46
SSGPMBGG2506	4.54	6	1	17.60	21.81	20.94	1.22	1.97	0.87	0.79	2.13	12.21
SSGPMBGG2512	4.54	12	1	23.54	33.82	26.89	1.22	1.97	0.87	0.79	2.13	14.77
SSGPMBGG2518	4.54	18	1	29.53	45.98	32.87	1.22	1.97	0.87	0.79	2.13	18.98
SSGPMBGG2524	4.50	24	1	35.55	57.87	38.90	1.22	1.97	0.87	0.79	2.13	19.56
SSGPMBGG3212	6.90	12	1 1/4	25.31	36.06	29.45	1.73	2.80	1.10	1.02	2.68	26.24
SSGPMBGG3218	6.90	18	1 1/4	31.69	48.43	35.83	1.73	2.80	1.10	1.02	2.68	29.98
SSGPMBGG3224	6.90	24	1 1/4	37.95	60.67	42.09	1.73	2.80	1.10	1.02	2.68	31.31
SSGPMBGG3812	9.71	12	1 1/2	26.57	37.09	31.73	2.05	2.80	1.38	1.10	3.15	40.79
SSGPMBGG3818	9.71	18	1 1/2	32.48	48.98	37.64	2.05	2.80	1.38	1.10	3.15	42.55
SSGPMBGG3824	9.71	24	1 1/2	38.58	61.06	43.74	2.05	2.80	1.38	1.10	3.15	48.50
SSGPMBGG4518	12.70	18	1 3/4	36.93	51.81	42.99	2.36	3.39	1.61	1.30	3.54	63.93
SSGPMBGG4524	12.70	24	1 3/4	42.87	63.82	48.94	2.36	3.39	1.61	1.30	3.54	72.75
SSGPMBGG5024	16.80	24	2	45.39	65.87	52.68	2.48	3.66	1.97	1.57	4.21	110.23
SSGPMBGG6424	27.20	24	2 1/2	49.41	72.09	58.27	2.95	4.49	2.24	1.61	5.63	194.01
SSGPMBGG6924	34.00	24	2 3/4	53.07	74.09	63.15	3.54	4.33	2.76	1.61	6.22	240.30

Sling Protection
Web Slings
Round Slings
Synthetic Chain Slings
Wire Rope Slings
Chain Slings
Shackles & Turnbuckles
Hooks & Links
Lifting Points
Hoists & Blocks
Lifting Devices
Pipe & Hose Restraints
The Down Assemblies
The Down Accessories
Towing & Recovery
Rope & Cordage